

CFC - 2 # # 2 # # ## - ## # # # - #

CRISTEK FILTERED CONNECTOR

SHELL CONFIGURATION
2 = M26482 (SEE SHT 2)

TYPE OF FILTER
C = C
P = Pi
L = L
T = T

FILTER CHARACTERISTICS
L = LOW RANGE
M = MEDIUM RANGE
T = STANDARD RANGE
H = HIGH RANGE
V = VERY HIGH RANGE

SERIES
2 = SERIES II, M26482

SHELL STYLE
B = NARROW FLANGE MOUNTING RECEPTACLE, BAYONET COUPLING
Y = JAM NUT MOUNTING RECEPTACLE, BAYONET COUPLING

SHELL FINISH
B = ELECTROLESS NICKEL (PREFERRED PLATING)
Y = YELLOW CHROMATE CADMIUM OVER NICKEL
O = OLIVE DRAB CADMIUM OVER NICKEL PLATE

SHELL SIZE
08 THRU 24

POLARIZATION
N - NORMAL
W
X
Y
Z

MODIFIER (FLANGE MOUNT)
0 - N/A
2 - #2-56 CLINCH NUT
4 - #4-40 CLINCH NUT

TERMINATION
P = PC TAIL
S = SOLDER CUP
W = WIRE WRAP

CONTACT TYPE
P = PIN
S = SOCKET

INSERT ARRANGEMENT NO.
- OBTAIN FROM MIL-STD-1669 PIN INSERT ARRANGEMENTS ON SHT. 3 OR 4. (SOCKET ARRANGEMENTS ARE OPPOSITE)

CRISTEK INTERCONNECTS, INC. www.cristek.com 1301 S. Lewis St. Anaheim, CA 92805 Phone: (714) 618-2000 FAX: (714) 535-4897	TITLE FILTERED CIRCULAR CONFORMING TO M26482, SERIES II	DWG. NO. CFC2	
	FILENAME ADS-CFC2-1	CODE IDENT NO. 67720	SHT 1 OF 4
		TOLERANCE: .XXX ±.005 .XX ±.01 ANGLE ±1°	

6.2 FILTER CONNECTORS / M26482

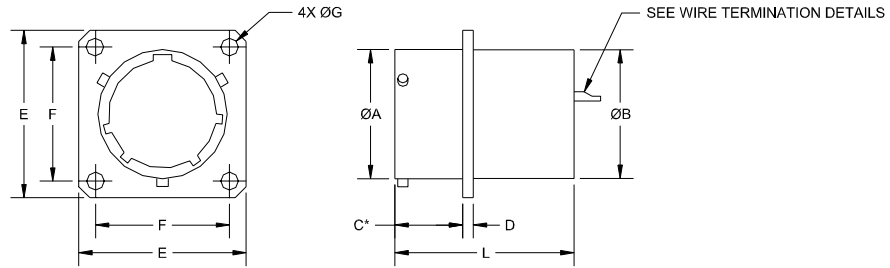

SHELL SIZE	ØA ±.003	ØB	C*	D	E ±.010	F BASIC	ØG	L
8	.471	.494	.457	.073	.818	.594	.120	1.210
10	.588	.620	.457	.073	.944	.719	.120	1.210
12	.748	.745	.457	.073	1.037	.812	.120	1.210
14	.873	.870	.457	.073	1.131	.906	.120	1.210
16	.998	.995	.457	.073	1.224	.969	.120	1.210
18	1.123	1.057	.457	.073	1.318	1.062	.120	1.210
20	1.248	1.182	.582	.105	1.443	1.156	.120	1.270
22	1.373	1.307	.582	.105	1.568	1.250	.120	1.270
24	1.498	1.432	.615	.105	1.693	1.375	.147	1.270

* = THIS DIMENSION MAY BE INCREASED TO LIMIT DISPLACEMENT IN THE BOX.

SQUARE FLANGE RECEPTACLE, MS3470 (STYLE B)

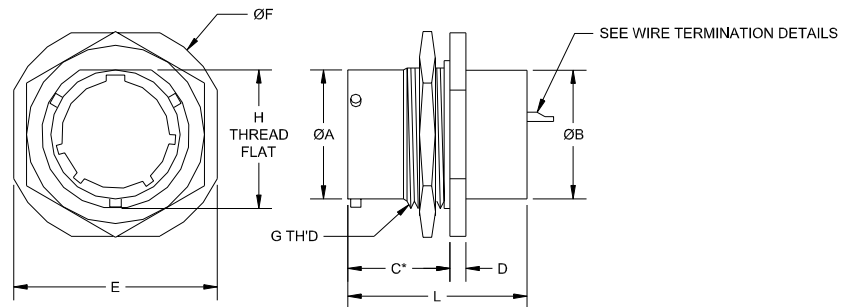

SHELL SIZE	ØA ±.003	ØB	C*	D	E ±.010	ØF ±.010	G TH'D UNEF-2A	H	L
8	.471	.494	.690	.108	.938	1.062	.5625-24	.525	1.210
10	.588	.620	.690	.108	1.062	1.187	.6875-24	.650	1.210
12	.748	.745	.690	.108	1.250	1.375	.875-20	.813	1.210
14	.873	.870	.690	.108	1.375	1.500	1.000-20	.937	1.210
16	.998	.995	.690	.108	1.500	1.625	1.125-18	1.061	1.210
18	1.123	1.057	.690	.108	1.625	1.812	1.250-18	1.186	1.210
20	1.248	1.182	.760	.143	1.812	1.938	1.375-18	1.311	1.270
22	1.373	1.307	.760	.143	1.938	2.062	1.500-18	1.436	1.270
24	1.498	1.432	.760	.143	2.062	2.187	1.625-18	1.561	1.270

* = THIS DIMENSION MAY BE INCREASED TO LIMIT DISPLACEMENT IN THE BOX.

JAM NUT MOUNTING RECEPTACLE, MS3474 (STYLE Y)

CRISTEK INTERCONNECTS, INC. www.cristek.com 1301 S. Lewis St. Anaheim, CA 92805 Phone: (714) 618-2000 FAX: (714) 535-4897	TITLE	DWG. NO.		
	FILTERED CIRCULAR CONFORMING TO M26482, SERIES II		CFC2	
	FILENAME	ADS-CFC2-2	CODE IDENT NO. 67720	SHT 2 OF 4
TOLERANCE: .XXX ±.005 .XX ±.01 ANGLE ±1°				

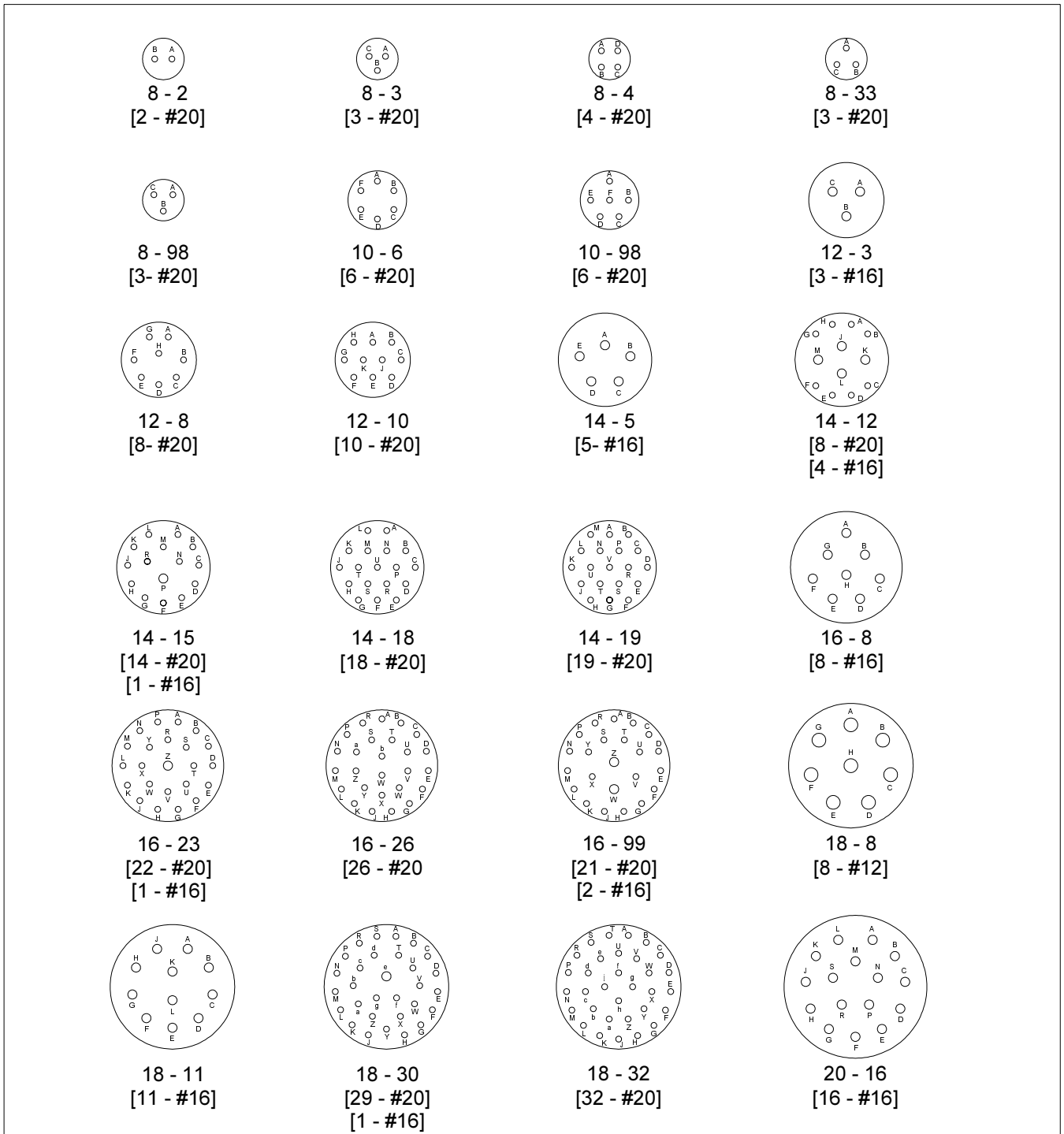

M26482 SERIES II INSERT ARRANGEMENTS FROM MIL-STD-1669

- ## = SERIES II SHELL SIZE - PIN ARRANGEMENT
 [## - ##] = QTY - SIZE OF CONTACTS

CRISTEK INTERCONNECTS, INC. www.cristek.com 1301 S. Lewis St. Anaheim, CA 92805 Phone: (714) 618-2000 FAX: (714) 535-4897	TITLE	DWG. NO.		
	FILTERED CIRCULAR CONFORMING TO M26482, SERIES II	CFC2		REV
		CODE IDENT NO. 67720	SHT 3 OF 4	A
FILE NAME	ADS-CFC2-3	TOLERANCE: .XXX ±.005 .XX ±.01 ANGLE ±1°		

6.2 FILTER CONNECTORS / M26482

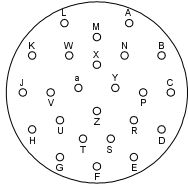

20 - 24
[24 - #20]

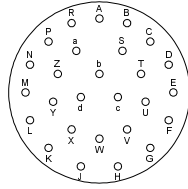

20 - 27
[27 - #20]

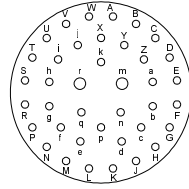

20 - 39
[37 - #20]
[2 - #16]

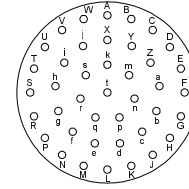

20 - 41
[41 - #20]

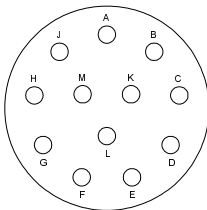

22 - 12
[12 - #12]

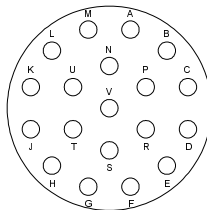

22 - 19
[19 - #12]

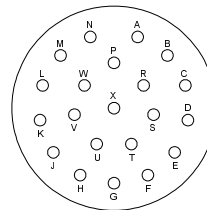

22 - 21
[21 - #16]

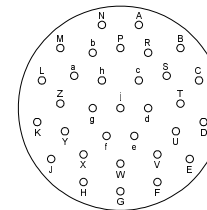

22 - 32
[32 - #20]

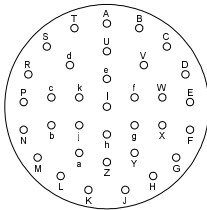

22 - 34
[34 - #20]

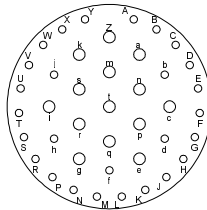

22 - 41
[27 - #20]
[14 - #16]

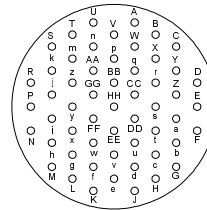

22 - 55
[55 - #20]

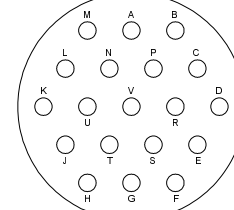

24 - 19
[19 - #12]

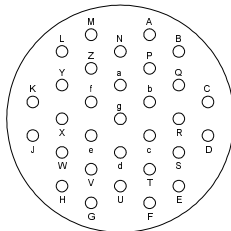

24 - 31
[31 - #16]

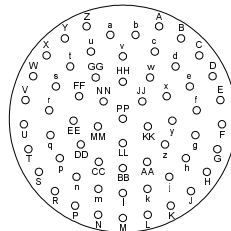

24 - 61
[61 - #20]

M26482 SERIES II INSERT ARRANGEMENTS FROM MIL-STD-1669

- ## = SERIES II SHELL SIZE - PIN ARRANGEMENT

[## - ##] = QTY - SIZE OF CONTACTS

CRISTEK INTERCONNECTS, INC. www.cristek.com 1301 S. Lewis St. Anaheim, CA 92805 Phone: (714) 618-2000 FAX: (714) 535-4897	TITLE	DWG. NO.		
	FILTERED CIRCULAR CONFORMING TO M26482, SERIES II	CFC2		
	FILE NAME	CODE IDENT NO.	SHT	REV
ADS-CFC2-4	67720	4 OF 4	A	
		TOLERANCE: .XXX ± .005 .XX ± .01 ANGLE ± 1°		